



**JACOBY-TARBOX**  
A Division Of The Clark • Reliance Corporation

**MODEL TLA EDUCTORS**

**INSTALLATION,  
OPERATING, & MAINTENANCE  
INSTRUCTIONS**

Section:	<b>E500</b>
Bulletin:	<b>E500.2</b>
Date:	<b>04/01/2000</b>
Supersedes:	<b>NEW</b>

These instructions for storage, installation, operation, maintenance and service of Jacoby-Tarbox Model TLA Eductors should be adequate to ensure long, satisfactory service.

This manual has been prepared as a guide to those involved in the installation, use, and maintenance of Jacoby-Tarbox (J-T) Model TLA Eductors. All instructions should be read and understood before beginning any installation, maintenance or operation of the J-T eductors. Failure to follow this manual could result in the leakage of fluid, injury to personnel, or property damage.

**Warning: Safety glasses should be worn when eductors are being installed or used in an area.**

**Introduction**

Eductors work by accelerating the motive fluid that is passed through them. It is important that outlet of the eductor be treated as an area of high velocity.

**Applications**

Eductor applications are sized using Jacoby-Tarbox Technical Bulletins. You can request these from J-T or your representative. For a specific application, a trained applications engineer will work with you.

Phone: 440 / 572-1500  
Fax: 440 / 238-8828  
E-mail: clark-reliance@multiverse.com

**Inspection**

Jacoby-Tarbox recommends that you inspect all eductors upon receipt. The material and size is stamped or cast into the side of the body on all units. If the size or material does not match your Purchase Order, contact J-T or your representative before installing the unit.

**Eductor Installation** should only be undertaken by experienced qualified personnel who are familiar with piping installation.

The user should refer to Jacoby-Tarbox dimension sheets or drawings to obtain dimensional information and design ratings for a specific product.

Eductors can be installed in any orientation and still perform properly. J-T recommends that qualified personnel review the installation to ensure that the desired results are achieved.

**All Piping used with Jacoby-Tarbox eductors should be clean and free of foreign matter that could clog the eductor.**

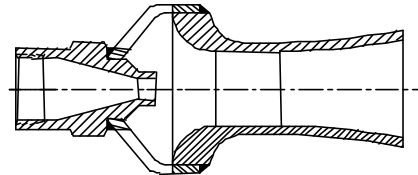

**OPTIONAL CONNECTIONS**

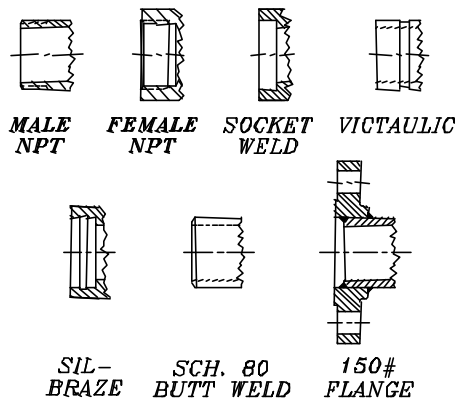

**JACOBY-TARBOX**  
A Division Of The Clark • Reliance Corporation

16633 FOLTZ INDUSTRIAL PARKWAY • STRONGSVILLE, OHIO 44149, USA  
PHONE: (440) 572-1500 • FAX: (440) 238-8828 • WWW.CLARK-RELIANCE.COM

